

Contact Information

ADD: He Yi Industry Park, Wuxing Industrial Zone, Oubei Town,
Yongjia County, Wenzhou City, Zhejiang, China

Tel: +86-577-67678989

Fax: +86-577-67678989

Cell: +86-158-6772-9999

Web: <http://www.verspec.com>

E-mail: info@verspec.com

Skype ID: verspec



Single Plate PFA Lined Swing Check valve

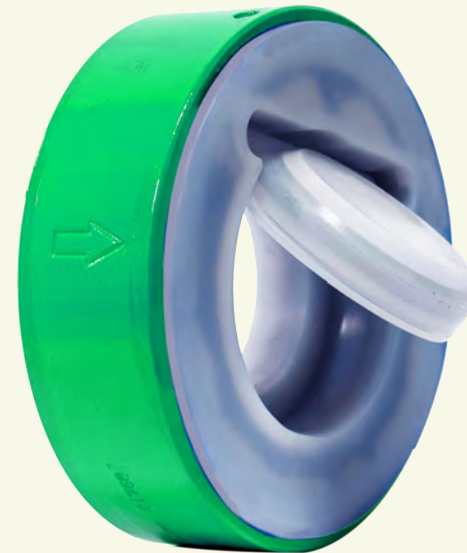

VerSpec Valve Wenzhou Co.,Ltd.

<http://www.verspec.com>

VH74-PFA Lined Single Plate Swing Check Valve

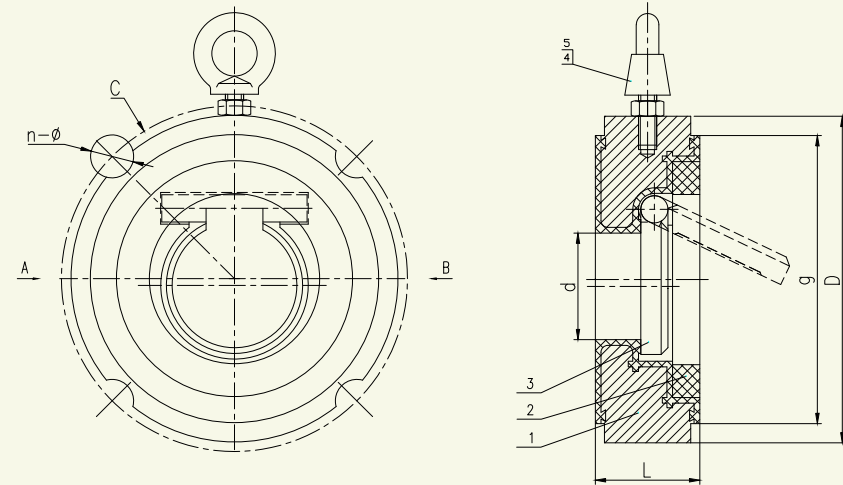
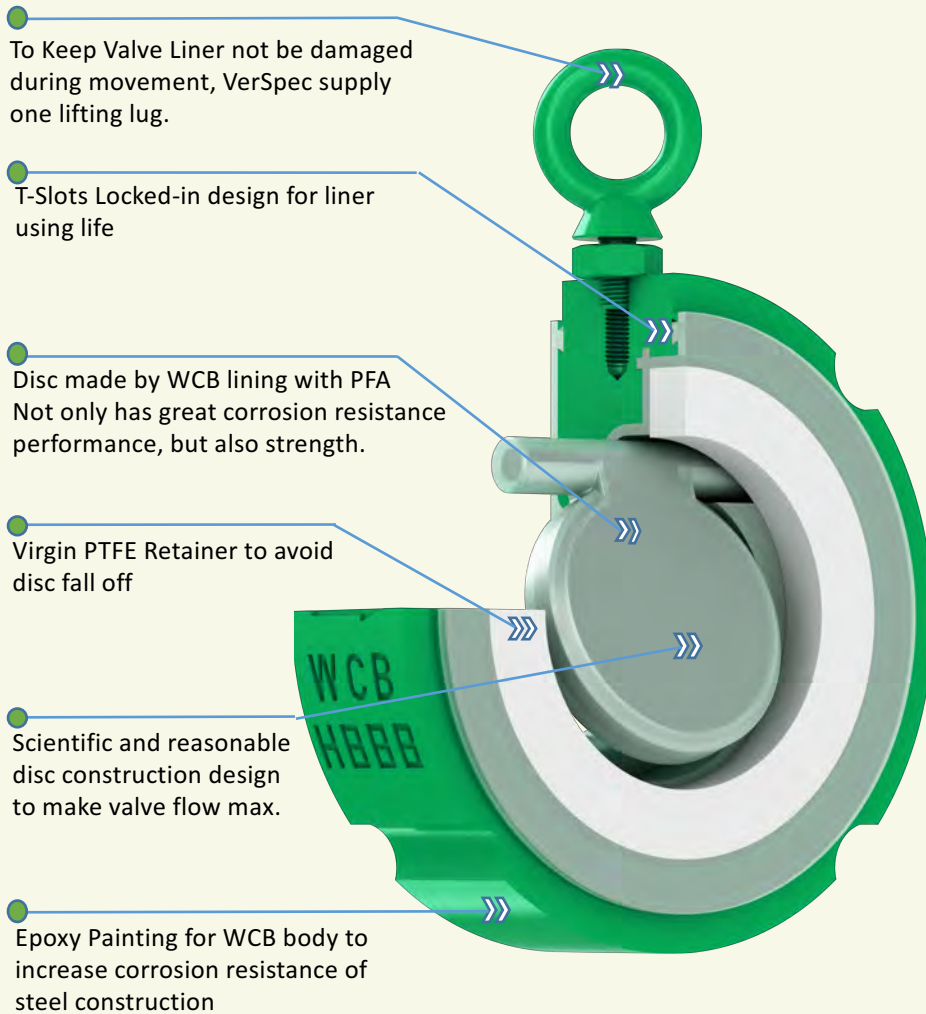

Specification

Design Standards	ASME, JIS, DIN, GB	Lining Material	PFA, PTFE, FEP, PO
Available Body Material	WCB, CF8, CF8M, Titanium	Available Temperature	-20°C~150°C
Liner thickness	> 3mm	Spark Test	14 KV

ASME B16.34 CLASS 150 Dimension Data

NPS	L	d	G	D	Liner Thickness	Weight (Kg)
2"	43	30	92.1	112.4	3.5	2.7
2.5"	46	55	104.8	131.2	3.5	3
3"	46	55	127	143.8	3.5	5
4"	52	72	157.2	181.7	3.5	6.8
6"	56	115	215.9	231.1	3.5	11
8"	60	155	269.9	288.1	3.5	19
10"	68	190	323.8	350.2	4	28
12"	78	240	381	419.9	4	39
14"	78	275	412.8	462.6	4	65
16"	102	305	469.9	526.4	4.5	90
18"	114	355	533.4	562.5	4.5	105
20"	127	405	584.2	619.6	4.5	165
24"	154	450	692.2	732.4	4.5	255